

.523
[13.28]

3.287
[83.49]

.200
[5.08]

2.055
[52.2]

2.665
[67.69]

TOP SURFACE 

M3 x 0.5 THREADED HOLE
0.16 [4.1] DEEP
6 PLACES ON SURFACE

M3x0.5 THREADED HOLE
0.16 [4.1] DEEP
2 PLACES ON SURFACE
2 ON OPP SURFACE

M3x0.5 THREADED HOLE
0.16 [4.1] DEEP
4 PLACES ON SURFACE

 2

.750 [19.05]

3.687 [93.65]

.225
[5.72]

.175
[4.45]

3.337
[84.76]

1.050
[26.67]

3.485
[88.52]

5.685 [144.4]

6.040 [153.42]

DIMENSION IN INCHES [MILLIMETERS]

 2

POWER AND CONTROL I/O CONNECTION IS A DUAL ROW, 30 POSITION
SAMTEC TFM CONNECTOR, SAMTEC P/N TFM-115-01-L-D-RA. MATING
CONNECTOR OPTIONS (AVAILABLE THROUGH SAMTEC AND CERTAIN
ELECTRONIC COMPONENT DISTRIBUTORS) ARE:

1) DISCRETE WIRE DUAL ROW CRIMP HOUSINGS (SAMTEC SFSD
OR SFSDT SERIES). SEE SAMTEC DATASHEETS FOR AVAILABLE
OPTIONS.

 1

DIRECT THERMAL ATTACHMENT TO THE TOP SURFACE OF THE RF MODULE
IS THE PREFERRED MOUNTING METHOD.

NOTES: (UNLESS OTHERWISE SPECIFIED)

THIRD ANGLE PROJECTION

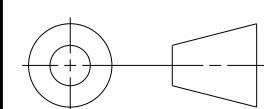

UNLESS OTHERWISE SPECIFIED
ALL DIMENSIONS SHOWN IN
INCHES [MILLIMETERS]

TOLERANCES ARE:
.XX [0.X] \pm .01 [0.25]
.XXX [0.XX] \pm .005 [0.13]
ANGLES: \pm 2°
MATERIAL

FINISH

REVISION NOTES

DATE

1. INITIAL RELEASE.



SignalCore Inc.

AUSTIN, TEXAS

TITLE

PART DRAWING
SC5508A

SIZE CAGE CODE NO.

C

6CG47

DATE OF DRAWING

07/23/2019

REV

1

SCALE: 1/1

DO NOT SCALE DRAWING

SHEET 1 OF 1